

EA PART NUMBER	TAPER SIZE	A	B	C	D	ANGLE	THREAD
EAPS-585X45	BT30	.709	.276	.433	.197	45	M12-1.75
EAPS-585X60	BT30	.709	.276	.433	.197	60	M12-1.75
EAPS-585X90	BT30	.707	.274	.431	.197	90	M12-1.75
EAPS-444X45	BT40	1.102	.390	.590	.236	45	M16-2
EAPS-444X60	BT40	1.102	.390	.590	.236	60	M16-2
EAPS-444X90	BT40	1.102	.390	.590	.236	90	M16-2
EAPS-446X45	BT50	1.378	.669	.906	.394	45	M24-3
EAPS-446X60	BT50	1.378	.669	.906	.394	60	M24-3
EAPS-446X90	BT50	1.378	.669	.906	.394	90	M24-3
EAPS-532X45	CAT40	.990	.390	.590	.236	45	5/8-11
EAPS-532X60	CAT40	.990	.390	.590	.236	60	5/8-11
EAPS-532X90	CAT40	.990	.390	.590	.236	90	5/8-11
EAPS-498	CAT40	.777	.390	.590	.200	90	5/8-11
EAPS-572X45	CAT40	.990	.390	.590	.120	45	5/8-11
EAPS-475	CAT40	.440	.490	.740	.120	45	5/8-11
EAPS-536X45	CAT50	1.386	.669	.906	.394	45	1.0-8
EAPS-536X60	CAT50	1.386	.669	.906	.394	60	1.0-8
EAPS-536X90	CAT50	1.386	.669	.906	.394	90	1.0-8
EAPS-275	CAT50	.700	.820	1.140	.200	45	1.0-8

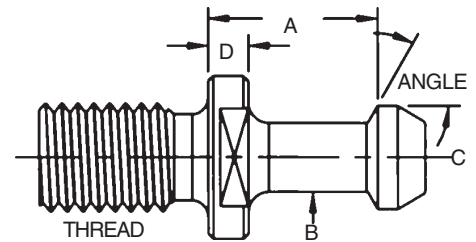

CALL FOR INFORMATION ON PULL STUDS NOT LISTED.

WARNING: The end user must verify that the retention knob received is correct for the machine. Different retention knobs may look similar, but they are not interchangeable. The use of the wrong retention knob can cause serious damage and possible injury.

Retention knobs should periodically be inspected. If there are signs of excessive wear or damage, the retention knob should be replaced.

COOLANT THRU

EA PART NUMBER	TAPER SIZE	A	B	C	D	ANGLE	THREAD
EAPSC-444X45	BT40	1.102	.390	.590	.236	45	M16-2
EAPSC-444X60	BT40	1.102	.390	.590	.236	60	M16-2
EAPSC-444X90	BT40	1.102	.390	.590	.236	90	M16-2
EAPSC-446X45	BT50	1.378	.669	.906	.394	45	M24-3
EAPSC-446X60	BT50	1.378	.669	.906	.394	60	M24-3
EAPSC-446X90	BT50	1.378	.669	.906	.394	90	M24-3
EAPSC-572X45	CAT40	.990	.390	.590	.120	45	5/8-11
EAPSC-572X60	CAT40	.990	.390	.590	.120	60	5/8-11
EAPSC-572X90	CAT40	.990	.390	.590	.120	90	5/8-11
EAPSC-552	CAT40	1.139	.406	.594	.187	45	5/8-11
EAPSC-475	CAT40	.440	.490	.740	.120	45	5/8-11
EAPSC-275	CAT50	.700	.820	1.140	.200	45	1.0-8
EAPSC-536X45	CAT50	1.386	.669	.906	.394	45	1.0-8
EAPSC-536X60	CAT50	1.386	.669	.906	.394	60	1.0-8
EAPSC-536X90	CAT50	1.386	.669	.906	.394	90	1.0-8

CALL FOR INFORMATION ON PULL STUDS NOT LISTED.