



EDWARD ANDREWS INTERNATIONAL

"Tooling and Workholding Specialist in the Metal Cutting Industry"

STERLING HEIGHTS, MICHIGAN

STRAIGHT SHANK

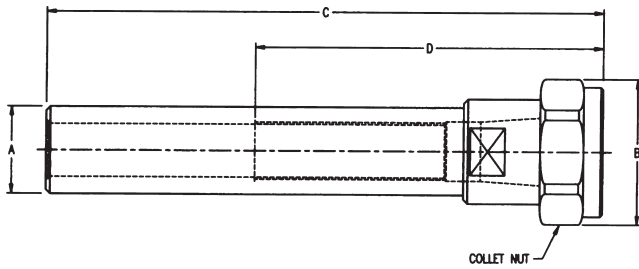

STRAIGHT SHANK TG COLLET CHUCKS

EA PART NUMBER	COLLET SERIES	COLLET RANGE	A DIA.	B DIA.	C	D	COLLET NUT	STOP SCREW	WRENCH
EASS125CH-075-800	TG075	.062-.750	1.250	2.18	8.00	4.00	EATGCN-075	13/16-LH	EATG075HW
EASS150CH-100-975	TG100	.093-1.000	1.500	2.44	9.75	6.00	EATGCN-100	1-1/8-LH	EATG100HW
EASS200CH-150-100	TG150	.500-1.500	2.000	3.25	10.00	6.00	EATGCN-150	1-5/8-LH	EATG150SW

Purchase collets separately.

Note! Collet must be assembled into collet nut before inserting tool or assembling onto chuck.

Note! Do not exceed the following torque recommendations: TG75 - 60lbs/ft TG100 - 75ft/lbs TG150 - 90ft/lbs

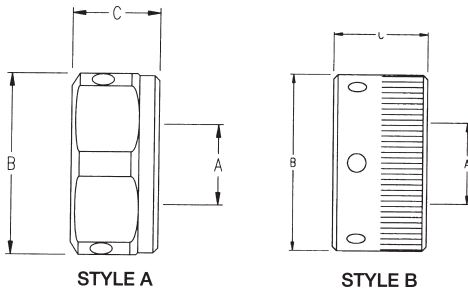

TG COLLET NUTS

EA PART NUMBER	COLLET SERIES	B	C	STYLE
EATGCN-075	TG075	2.18	.910	A
*EATGCN-100	TG100	2.44	1.10	A
EATGCN-150	TG150	3.25	1.75	B

*Hex or Spanner wrenches will work.

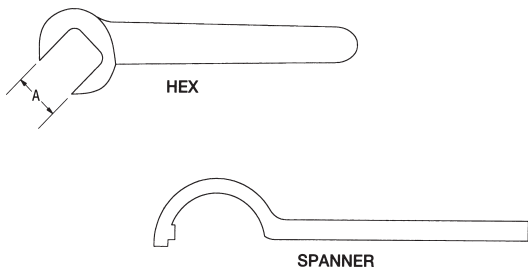

TG WRENCHES

EA PART NUMBER	COLLET NUT	A	STYLE
EATG075HW	EATGCN-075	1.88	HEX
EATG100HW	EATGCN-100	2.25	HEX
EATG100SW	EATGCN-100	2.44	SPANNER
EATG150SW	EATGCN-150	3.25	SPANNER

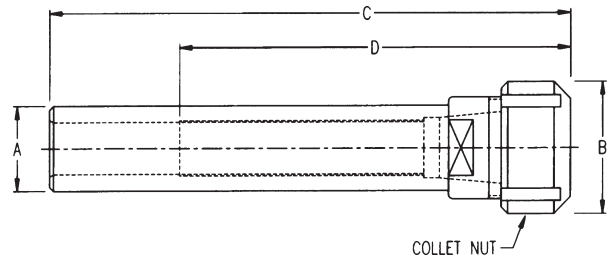

STRAIGHT SHANK ER COLLET CHUCKS

EA PART NUMBER	COLLET SERIES	COLLET RANGE	A DIA.	B	C DIA.	D	STOP SCREW	COLLET NUT	WRENCH
EASS050ER-11-660	ER11	.019-.276	.500	.64	6.60	3.50	EAERCN-11M	5/16LH	EAER11MW
EASS075ER-16-700	ER16	.019-.393	.750	.870	7.00	4.00	EAERCN-16M	7/16LH	EAER16MW
EASS100ER-20-700	ER20	.039-.511	1.00	1.10	7.00	4.00	EAERCN-20M	9/16LH	EAER20MW
EASS100ER-25-700	ER25	.039-.630	1.00	1.61	7.00	4.00	EAERCN-25	5/8LH	EAER25SW
EASS125ER-32-750	ER32	.078-.787	1.25	1.97	7.50	4.00	EAERCN-32	7/8LH	EAER32SW

Purchase collets separately.

Note! Collet must be assembled into collet nut before inserting tool or assembling onto chuck.

Note! Do not exceed the following torque recommendations:

ER11 - 25 ft/lbs ER16 - 40ft/lbs ER20 - 70 ft/lbs ER32 - 80ft/lbs ER40 - 90ft/lbs

ER COLLET NUTS

EA PART NUMBER	COLLET SERIES	A	B	STYLE	WRENCH
EAERCN-11M	ER11	.64	.43	A	EAER11MW
EAERCN-11	ER11	.74	.43	B	EAER11HW
EAERCN-16M	ER16	.870	.670	A	EAER16MW
EAERCN-16	ER16	1.10	.670	B	EAER16HW
EAERCN-20M	ER20	1.10	.750	A	EAER20MW
EAERCN-20	ER20	1.34	.750	B	EAER20HW
EAERCN-25	ER25	1.61	.790	C	EAER25SW
EAERCN-32	ER32	1.97	.870	C	EAER32SW
EAERCN-40	ER40	2.46	1.12	C	EAER40SW
EAERCN-50	ER50	3.10	1.39	C	EAER50SW

**STYLE A
MINI**

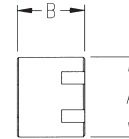

**STYLE B
HEX**

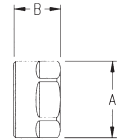

**STYLE C
SPANNER**

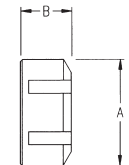

ER WRENCHES

EA PART NUMBER	COLLET NUT	A	STYLE
EAER11MW	EAERCN-11M	.630	A
EAER11HW	EAERCN-11	.670	B
EAER16MW	EAERCN-16M	.870	A
EAER16HW	EAERCN-16	1.00	B
EAER20MW	EAERCN-20M	1.10	A
EAER20HW	EAERCN-20	1.18	B
EAER25SW	EAERCN-25	1.65	C
EAER32SW	EAERCN-32	1.97	C
EAER40SW	EAERCN-40	2.46	C
EAER50SW	EAERCN-50	3.10	C

**STYLE A
MINI**

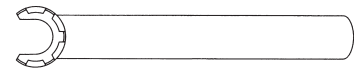

**STYLE B
HEX**

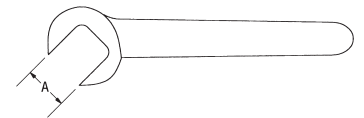

**STYLE C
SPANNER**

