



# EDWARD ANDREWS INTERNATIONAL

"Tooling and Workholding Specialist in the Metal Cutting Industry"

STERLING HEIGHTS, MICHIGAN

CAT 50

## METRIC END MILL ADAPTER - CAT50

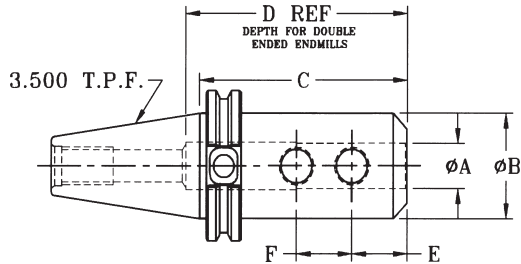

EA PART NUMBER	A DIA.	B DIA.	C	D	E	F	SET SCREW	ENDMILL TYPE
EAV50E-6MM-250	6MM	.875	2.50	----	.44	----	M6 W	DOUBLE END
EAV50E-8MM-250	8MM	1.00	2.50	----	.44	----	M8 W	
EAV50E-10MM-250	10MM	1.00	2.50	----	.74	----	M10 W	
EAV50E-12MM-262	12MM	1.25	2.62	----	.88	----	M12 W	
EAV50E-16MM-375	16MM	1.50	3.75	----	.94	----	M16 W	
EAV50E-20MM-375	20MM	1.75	3.75	----	1.00	----	M16 W	
EAV50E-25MM-400	25MM	2.00	4.00	4.50	1.12	1.00	M20 W	SINGLE END
EAV50E-32MM-400	32MM	2.50	4.00	2.52	1.12	1.00	M20 W	

Order retention knobs separately, specify machine make and model#.

## INCH STUB LENGTH END MILL ADAPTER- CAT50

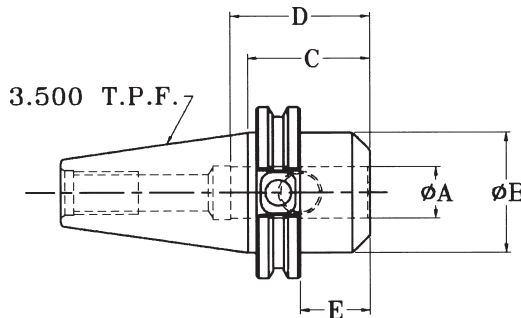

EA PART NUMBER	A DIA.	B DIA.	C	D	E	SET SCREW	ENDMILL TYPE
EAV50E-062-206	.625	2.75	2.06	----	.94	9/16-18W	SINGLE OR DOUBLE
EAV50E-075-206	.750	2.75	2.06	----	1.00	5/8-18W	
EAV50E-100-225	1.00	2.75	2.25	4.50	1.12	3/4-16W	
EAV50E-125-225	1.25	2.75	2.25	2.75	1.12	3/4-16W	SINGLE END
EAV50E-150-275	1.50	2.75	2.75	2.75	1.12	3/4-16W	

Order retention knobs separately, specify machine make and model#.

## INCH STANDARD LENGTH END MILL ADAPTER - CAT50

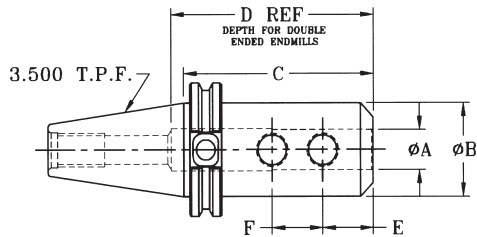

EA PART NUMBER	A DIA.	B DIA.	C	D	E	F	SET SCREW	ENDMILL TYPE
EAV50E-018-250	.1875	.68	2.50	----	.56	----	1/4-28W	SINGLE OR DOUBLE END
EAV50E-025-250	.250	.875	2.50	----	.56	----	1/4-28W	
EAV50E-031-250	.3125	1.00	2.50	----	.56	----	1/4-28W	
EAV50E-038-250	.375	1.00	2.50	----	.75	----	3/8-24W	
EAV50E-044-250	.4375	1.25	2.50	----	.75	----	3/8-24W	
EAV50E-050-262	.500	1.25	2.62	----	.88	----	7/16-20W	
EAV50E-062-375	.625	1.50	3.75	----	.94	----	9/16-18W	
EAV50E-075-375	.750	1.75	3.75	----	1.00	----	5/8-18W	
EAV50E-088-375	.875	2.00	3.75	4.00	1.00	.81	5/8-18W	
EAV50E-100-400	1.000	2.00	4.00	4.50	1.12	1.00	3/4-16W	
EAV50E-125-400	1.250	2.50	4.00	2.50	1.12	1.00	3/4-16W	SINGLE END
EAV50E-150-400	1.500	2.75	4.00	2.75	1.50	1.00	3/4-16W	
EAV50E-175-400	1.750	3.12	4.00	2.75	1.12	1.00	3/4-16W	
EAV50E-200-562	2.000	3.75	5.62	3.50	1.41	1.50	1"-14W	

Order retention knobs separately, specify machine make and model#.

**INCH EXTENDED LENGTH END MILL ADAPTERS - CAT50**

EA PART NUMBER	A DIA.	B DIA.	C	D	E	F	SET SCREW	ENDMILL TYPE
EAV50E-018-450	.1875	.68	4.50	----	.56	----	1/4-28W	SINGLE OR DOUBLE END
EAV50E-025-450	.250	.875	4.50	----	.56	----	1/4-28W	
EAV50E-031-450	.3125	1.00	4.50	----	.56	----	1/4-28W	
EAV50E-038-450	.375	1.00	4.50	----	.75	----	3/8-24W	
EAV50E-044-450	.4375	1.25	4.50	----	.75	----	3/8-24W	
EAV50E-050-462	.500	1.25	4.62	----	.88	----	7/16-20W	
EAV50E-062-575	.625	1.50	5.75	----	.94	----	9/16-18W	
EAV50E-075-575	.750	1.75	5.75	----	1.00	----	5/8-18W	
EAV50E-088-575	.875	2.00	5.75	4.00	1.00	.81	5/8-18W	
EAV50E-100-600	1.000	2.00	6.00	4.50	1.12	1.00	3/4-16W	
EAV50E-125-600	1.250	2.50	6.00	2.50	1.12	1.00	3/4-16W	SINGLE END
EAV50E-150-600	1.500	2.75	6.00	2.75	1.50	1.00	3/4-16W	
EAV50E-200-762	2.000	3.75	7.62	3.50	1.41	1.50	1"-14W	

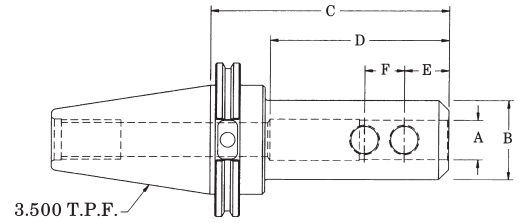

Order retention knobs separately, specify machine make and model#.

**INCH EXTRA EXTENDED LENGTH END MILL ADAPTERS - CAT50**

EA PART NUMBER	A DIA.	B DIA.	C	D	E	F	SET SCREW	END MILL TYPE
EAV50E-018-650	.1875	.68	6.50	----	.56	----	1/4-28W	SINGLE OR DOUBLE END
EAV50E-025-650	.250	.875	6.50	----	.56	----	1/4-28W	
EAV50E-031-650	.3125	1.00	6.50	----	.56	----	1/4-28W	
EAV50E-038-650	.375	1.00	6.50	----	.75	----	3/8-24W	
EAV50E-044-650	.4375	1.25	6.50	----	.75	----	3/8-24W	
EAV50E-050-662	.500	1.25	6.62	----	.88	----	7/16-20W	
EAV50E-062-775	.625	1.50	7.75	----	.94	----	9/16-18W	
EAV50E-075-775	.750	1.75	7.75	----	1.00	----	5/8-18W	
EAV50E-088-775	.875	2.00	7.75	4.00	1.00	.81	5/8-18W	
EAV50E-100-800	1.000	2.00	8.00	4.50	1.12	1.00	3/4-16W	
EAV50E-125-800	1.250	2.50	8.00	2.50	1.12	1.00	3/4-16W	SINGLE END
EAV50E-150-800	1.500	2.75	8.00	2.75	1.50	1.00	3/4-16W	
EAV50E-200-962	2.000	3.75	9.62	3.50	1.41	1.50	1"-14W	

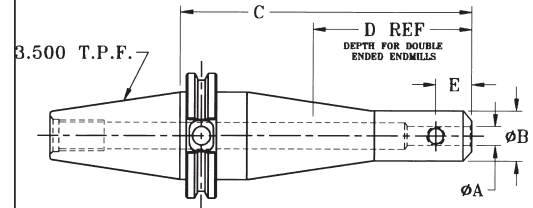

Order retention knobs separately, specify machine make and model#.

**DOUBLE ANGLE COLLET CHUCKS - CAT50**

EA PART NUMBER	COLLET SERIES	A COLLET RANGE	B DIA.	C	D	COLLET NUT	STOP SCREW	COLLET NUT WRENCH
EAV50DA-100-300	DA100	.062-.56	1.39	3.00	3.00	EADACN-100	5/8-LH	EADA10W
EAV50DA-100-600	DA100	.062-.56	1.39	6.00	3.00	EADACN-100	5/8-LH	EADA10W
EAV50DA-180-300	DA180	.062-.75	1.70	3.00	4.04	EADACN-180	13/16-LH	EADA18W
EAV50DA-180-600	DA180	.062-.75	1.70	6.00	4.04	EADACN-180	13/16-LH	EADA18W

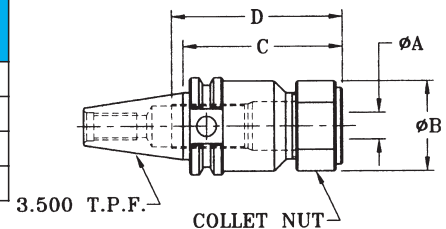

Includes collet nut and standard stop screw. Purchase collets and wrenches separately. Note! Do not exceed the following torque recommendations:  
 DA100 - 35 ft/lbs DA180 - 45 ft/lbs



# EDWARD ANDREWS INTERNATIONAL

"Tooling and Workholding Specialist in the Metal Cutting Industry"

STERLING HEIGHTS, MICHIGAN

CAT 50

## TG COLLET CHUCKS - CAT50

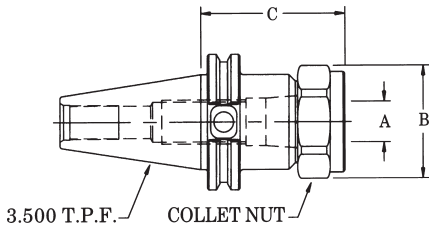

EA PART NUMBER	COLLET SERIES	A COLLET RANGE	B DIA.	C	D	COLLET NUT	STOP SCREW	COLLET NUT WRENCH
EAV50CH-100-300	TG100	.093-1.000	2.44	3.00	4.50	EATGCN-100	1-1/8-LH	EATG100HW
EAV50CH-100-550	TG100	.093-1.000	2.44	5.50	7.00	EATGCN-100	1-1/8-LH	EATG100HW
EAV50CH-100-750	TG100	.093-1.000	2.44	7.50	9.00	EATGCN-100	1-1/8-LH	EATG100HW
EAV50CH-150-300	TG150	.500-1.500	3.25	3.00	4.50	EATGCN-150	1-5/8-LH	EATG150SW
EAV50CH-150-500	TG150	.500-1.500	3.25	5.00	7.00	EATGCN-150	1-5/8-LH	EATG150SW
EAV50CH-150-700	TG150	.500-1.500	3.25	7.00	9.00	EATGCN-150	1-5/8-LH	EATG150SW
EAV50CH-200-400	TG200	1.000-2.000	4.25	4.00	5.25	EATGCN-200	2-1/8-LH	EATG200SW

Order retention knobs separately, specify machine make and model#.

Includes collet nut and standard stop screw. Purchase collets and wrenches separately. Note! Collet must be assembled into collet nut before inserting tool or assembling onto chuck. Note! Do not exceed the following torque recommendations: TG100 - 75ft/lbs TG150 - 90ft/lbs TG200 - 120ft/lbs.

## ER COLLET CHUCKS - CAT50

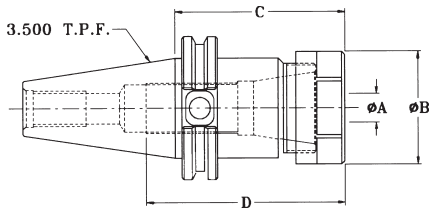

EA PART NUMBER	COLLET SERIES	A COLLET RANGE	B DIA.	C	D	COLLET NUT	STOP SCREW	COLLET NUT WRENCH
EAV50ER-16-400	ER16	.019-.393	1.10	4.00	3.00	EAERCN-16	7/16-LH	EAER16HW
EAV50ER-16-500	ER16	.019-.393	1.10	5.00	3.00	EAERCN-16	7/16-LH	EAER16HW
EAV50ER-16-700	ER16	.019-.393	1.10	7.00	3.00	EAERCN-16	7/16-LH	EAER16HW
EAV50ER-20-400	ER20	.039-.511	1.34	4.00	3.00	EAERCN-20	9/16-LH	EAER20HW
EAV50ER-20-600	ER20	.039-.511	1.34	6.00	3.00	EAERCN-20	9/16-LH	EAER20HW
EAV50ER-25-400	ER25	.039-.630	1.65	4.00	3.00	EAERCN-25	5/8-LH	EAER25SW
EAV50ER-25-600	ER25	.039-.630	1.65	6.00	3.00	EAERCN-25	5/8-LH	EAER25SW
EAV50ER-32-400	ER32	.078-.787	1.97	4.00	3.00	EAERCN-32	7/8-LH	EAER32SW
EAV50ER-32-650	ER32	.078-.787	1.97	6.50	3.00	EAERCN-32	7/8-LH	EAER32SW
EAV50ER-40-400	ER40	.118-1.024	2.48	4.00	3.00	EAERCN-40	1-1/8-LH	EAER40SW
EAV50ER-40-630	ER40	.118-1.024	2.48	6.30	3.00	EAERCN-40	1-1/8-LH	EAER40SW
EAV50ER-50-400	ER50	.394-1.339	3.07	4.00	3.00	EAERCN-50	1-1/2-LH	EAER50SW

Order retention knobs separately, specify machine make and model#.

Includes collet nut and standard stop screw. Purchase collets and wrenches separately. Note! Collet must be assembled into the collet nut before inserting tool or assembling onto chuck. Note! Do not exceed the following torque recommendations: ER16 - 40ft/lbs ER20 - 65ft/lbs ER25 - 65ft/lbs ER32 - 80ft/lbs ER40 - 90ft/lbs ER50 - 90ft/lbs.

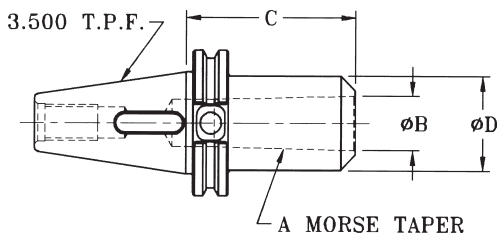

## MORSE TAPER ADAPTERS - CAT50

EA PART NUMBER	A MORSE TAPER	B DIA.	C	D DIA.
EAV50-MT2	2	.700	2.00	1.25
EAV50-MT3	3	.938	2.50	1.62
EAV50-MT4	4	1.231	3.38	2.00
EAV50-MT5	5	1.748	3.75	2.75

Order retention knob separately, specify machine make and model#.

## BLANK BARS - CAT50

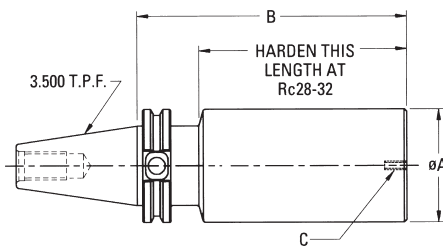

EA PART NUMBER	A DIA.	B	C TAPPED HOLE	MATERIAL
EAV50BB-400-600	4.00	6.00	1/4-20X3/4"	PHT 4150
EAV50BB-400-800	4.00	8.00	1/4-20X3/4"	
EAV50BB-600-1200	6.00	12.00	1/4-20X3/4"	

Order retention knob separately, specify machine make and model#.

## SHELL MILL ADAPTERS - CAT50

EA PART NUMBER	A DIA.	B DIA.	C	D	E KEY	F THREAD	G SCREW
EAV50SM-075-150	.750	2.750	1.50	.68	.31	3/8-24	B5002
EAV50SM-075-350	.750	1.750	3.50	.68	.31	3/8-24	B5002
EAV50SM-075-550	.750	1.750	5.50	.68	.31	3/8-24	B5002
EAV50SM-100-200	1.000	2.190	2.00	.68	.38	1/2-20	B5003
EAV50SM-100-400	1.000	2.190	4.00	.68	.38	1/2-20	B5003
EAV50SM-100-600	1.000	2.190	6.00	.68	.38	1/2-20	B5003
EAV50SM-125-150	1.250	2.750	1.50	.68	.50	5/8-18	B5004
EAV50SM-125-350	1.250	2.880	3.50	.68	.50	5/8-18	B5004
EAV50SM-125-550	1.250	2.880	5.50	.68	.50	5/8-18	B5004
EAV50SM-150-240	1.500	3.810	2.40	.93	.62	3/4-16	B5005
EAV50SM-150-400	1.500	3.810	4.00	.93	.62	3/4-16	B5005
EAV50SM-150-600	1.500	3.810	6.00	.93	.62	3/4-16	B5005
*EAV50SM-200-240	2.000	4.875	2.40	.93	.75	1"-14	B5006
*EAV50SM-200-400	2.000	4.875	4.00	.93	.75	1"-14	B5006
*EAV50SM-200-600	2.000	4.875	6.00	.93	.75	1"-14	B5006
*EAV50SM-250-240	2.500	4.875	2.40	1.125	1.00	1"-14	B5007
*EAV50SM-250-400	2.500	4.875	4.00	1.125	1.00	1"-14	B5007
*EAV50SM-250-600	2.500	4.875	6.00	1.125	1.00	1"-14	B5007

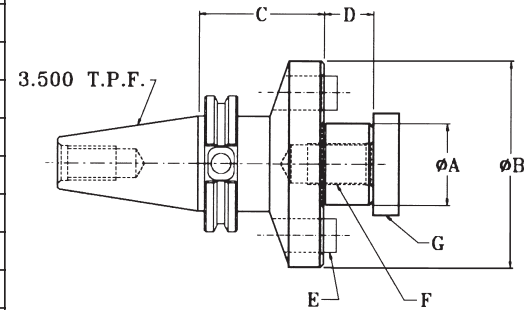

Order retention knobs separately, specify machine make and model#.

Includes shell screw and key drives.

\* Includes (4) 5/8-11 tapped holes on a 4" bolt circle.

## JACOBS TAPER ADAPTERS - CAT50

EA PART NUMBER	A JACOBS TAPER	B DIA.
EAV50-JT2	2	.559
EAV50-JT3	3	.811
EAV50-JT4	4	1.12
EAV50-JT6	6	.676
EAV50-JT33	33	.624

Order retention knobs separately, specify machine make and model#.

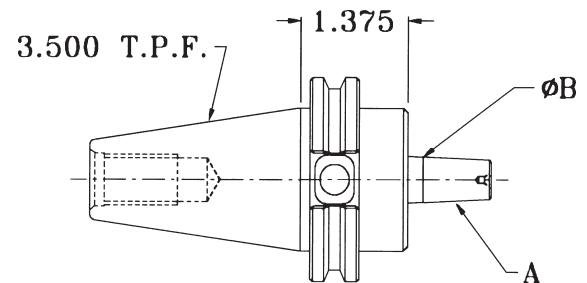

## STUB ARBOR SCREW TYPE - CAT50

EA PART NUMBER	A DIA.	B	C SCREW	D THREAD	E SPACER	F KEY
EAV50SA-125-400	1.25	4.00	B5004	5/8-18	B6041	.312
EAV50SA-150-400	1.50	4.00	B5005	3/4-16	B6051	.375

Order retention knobs separately, specify machine make and model#.

Includes 1/4 and 1/2 spacers, key and shell screw.

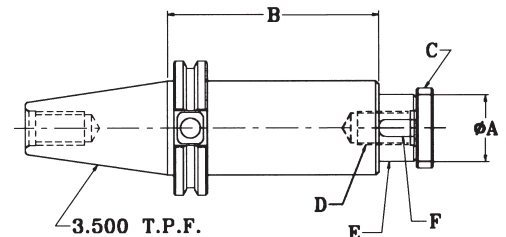

## STUB ARBOR NUT TYPE

EA PART NUMBER	A DIA.	B	C	D NUT	E KEY	F SPACER
EAV50SAN-125-400	1.25	4.00	6.44	B5040	.312	B6040
EAV50SAN-150-400	1.50	4.00	6.69	B5060	.375	B6050

Order retention knobs separately, specify machine make and model#.

Includes 3 spacers 1/8, 3/8, 3/4, key and nut.

