

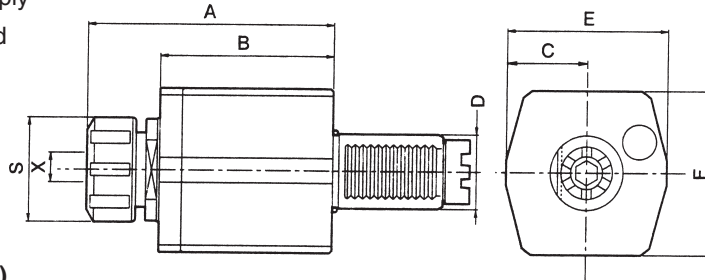

AXIAL DRILLING AND MILLING HEAD WITH MT DRIVE COUPLING

- Uses ER collets
- External coolant supply
- Collet is not included

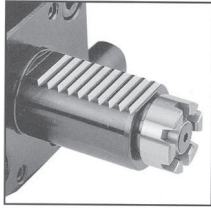

MT (BARUFFALDI TYPE)

EA PART NUMBER	D DIN 69880	X CAPACITY	S	MAX RPM	i	A	B	C	E	F
VDI DA20-MT-ER16	20	1-10	ER16	32	6000	1:1	76	48	25	50
VDI DA30-MT-ER25	30	1-16	ER25	42	6000	1:1	86	55	33	66
VDI DA40-MT-ER32	40	2-20	ER32	50	6000	1:1	89	55	39	78
VDI DA50-MT-ER40	50	3-26	ER40	63	6000	1:1	123	81.5	40	88

AXIAL TENSION COMPRESSION TAPPING HEADS ALSO AVAILABLE.

RADIAL DRILLING AND MILLING HEAD WITH MT DRIVE COUPLING

- Uses ER collets
- External coolant supply
- Collet is not included

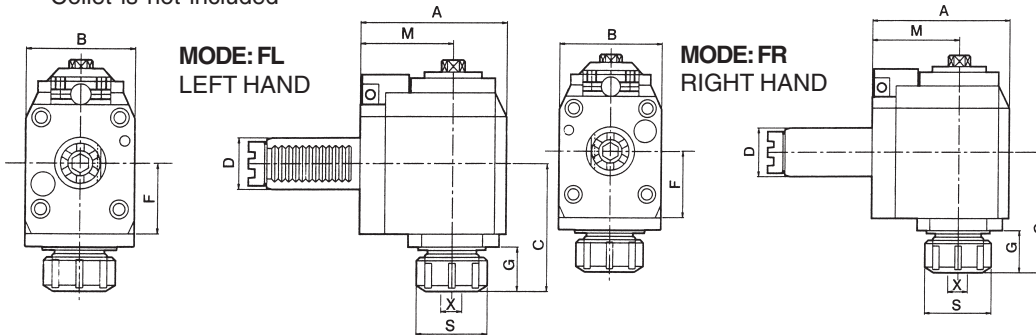

EA PART NUMBER	D DIN 69880	X CAPACITY	S	MAX RPM	i	A	B	C	F	G	M	
VDI FR30-MT2565	30	1-16	ER25	42	5000	1:1	97	64	74.5	41	26	65
VDI FL30-MT2565												
VDI FR30-MT2585	30	1-16	ER25	42	5000	1:1	117	64	74.5	41	26	85
VDI FL30-MT2585												
VDI FR40-MT3265	40	2-20	ER32	50	5000	1:1	99	80	71	40	23	65
VDI FL40-MT3265												
VDI FR40-MT3285	40	2-20	ER32	50	5000	1:1	119	80	71	40	23	85
VDI FL40-MT3285												
VDI FR40-MT32100	40	2-20	ER32	50	5000	1:1	134	80	71	40	23	100
VDI FL40-MT32100												
VDI FR50-MT4075	50	3-26	ER40	60	5000	1:1	115	88	103	56	40	75
VDI FL50-MT4075												

NOTE: OUTPUT ROTATION IS OPPOSITE INPUT ROTATION.
RADIAL TENSION COMPRESSION TAPPING HEADS ALSO AVAILABLE.

OFFSET AXIAL DRILLING AND MILLING HEAD WITH MT DRIVE COUPLING

- Uses ER collets
- External coolant supply
- Collet is not included

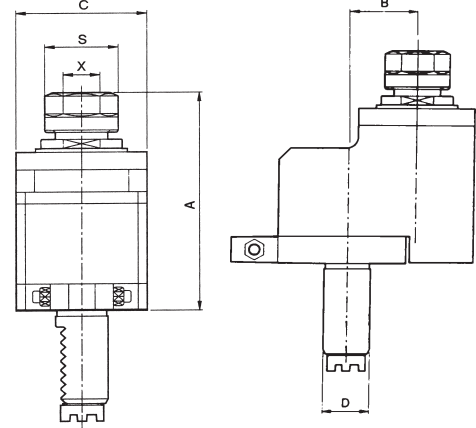

EA PART NUMBER	D DIN 69880	X CAPACITY	S	MAX RPM	i	A	B	C
VDI DA20-MT1629	20	1-10 ER16	32	4000	1:1	93.5	29	50
VDI DA30-MT2529	30	1-16 ER25	42	4000	1:1	100	29	60
VDI DA30-MT2529/1	30	1-16 ER25	42	8000	1:2	100	29	60
VDI DA40-MT3250	40	2-20 ER32	50	4000	1:1	113	50	80
VDI DA50-MT4065	50	3-26 ER40	63	3000	1:1	124	65	86

NOTE: OUTPUT ROTATION IS OPPOSITE INPUT ROTATION.

OFFSET RADIAL DRILLING AND MILLING HEAD WITH MT DRIVE COUPLING

- Uses ER collets
- External coolant supply
- Collet is not included

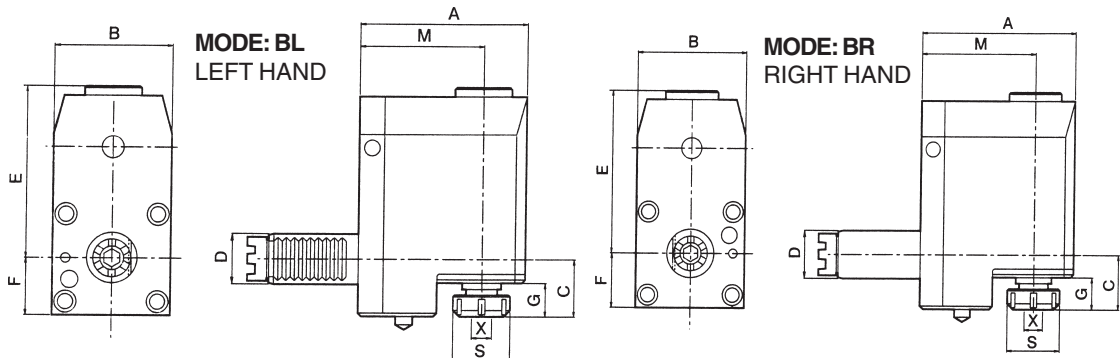

EA PART NUMBER	D DIN 69880	X CAPACITY	S	MAX RPM	i	A	B	C	E	F	G	M
VDI BR20-MT1657	20	1-10 ER16	32	5000	1:1	80	50	43	63	27	29	57
VDI BL20-MT1657												
VDI BR30-MT2569	30	1-16 ER25	42	5000	1:1	95	60	42	76	32	29	69
VDI BL30-MT2569												
VDI BR40-MT3290	40	2-20 ER32	50	5000	1:1	124	80	44	110	42	34	90
VDI BL40-MT3290												
VDI BR50-MT4090	50	3-26 ER40	63	5000	1:1	129	86	49	112	45	39	90
VDI BL50-MT4090												

OFFSET RADIAL TENSION COMPRESSION TAPPING HEADS ALSO AVAILABLE.