

TOOL HOLDER BUSHINGS

STYLE "BJ"

EDWARD ANDREWS Style "BJ" Bushings are used to adapt drills, boring bars or shank type tools, with or without flats, to the standard bore of the turret or tool holder on the machine.

The Style "BJ" Bushing combines the designs for the standard Style "B" split bushing and the standard Style "J" set screw clearance bushing enabling it to be used as either a conventional Style "B" or Style "J" Bushing. They also feature our stepped head design for easy removal.

MADE IN THE U.S.A. OF THRU HARDENED ALLOY AND PRECISION GROUND.



BUSHINGS HAVE 2 HOLES EXCEPT BUSHINGS 2½" O.D. AND LARGER WITH AT LEAST 1¼" I.D. HAVE 4 HOLES.

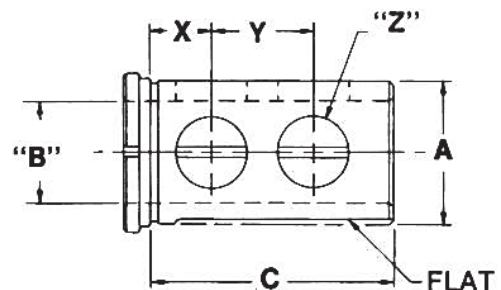
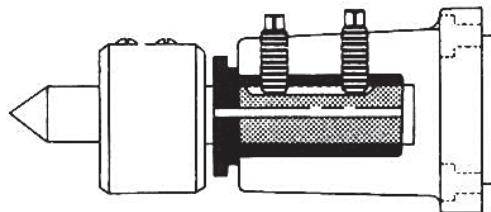

EA PART NUMBER	BUSHING DIA.	STANDARD BORE SIZES STOCKED*	LENGTH UNDER HEAD	LENGTH DIMENSIONS		HOLE SIZE
	A			B	C	
EA68-23BJ	1-1/2	3/8, 1/2, 5/8, 3/4, 7/8, 1, 1-1/4	2-1/2	11/16	1-1/8	7/8
EA68-24BJ	1-3/4	1/2, 5/8, 3/4, 7/8, 1, 1-1/4, 1-1/2	3	3/4	1-1/4	7/8
EA68-25BJ	2	1/2, 5/8, 3/4, 7/8, 1, 1-1/4, 1-1/2, 1-3/4	3-1/2	3/4	1-1/2	1
EA68-26BJ	2-1/2	1/2, 5/8, 3/4, 7/8, 1, 1-1/4, 1-1/2, 1-3/4, 2, 2-1/4	4	7/8	1-3/4	1-1/4
EA68-27BJ	3	1, 1-1/4, 1-1/2, 1-3/4, 2, 2-1/4, 2-1/2	4-1/2	1	2	1-1/4
EA68-28BJ	3-1/2	1-1/2, 1-3/4, 2, 2-1/4, 2-1/2, 3	5-1/4	1-1/4	2-1/2	1-1/4

* Special Sizes Available.

WHEN ORDERING BUSHINGS, SPECIFY EA PART NUMBER AND BORE SIZE REQUIRED.