



SAMCHULLY
 SOFT JAWS

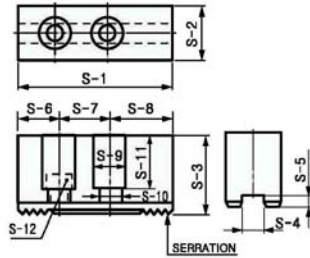

Fig 1

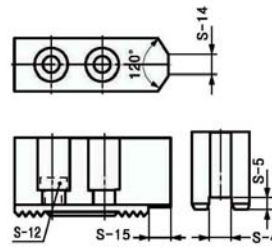

Fig 2

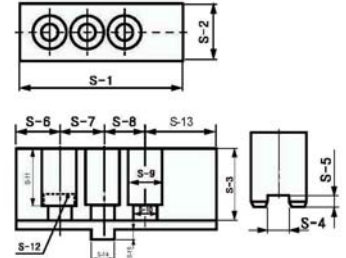

Fig 3

Dimensions

Part Number	Fig.	Serration Pitch	S-1	S-2	S-3	S-4	S-5	S-6	S-7	S-8	S-9	S-10	S-11	S-12	S-13	S-14	S-15	Corresponding Chuck
SB04C1	2	1.5X60°	48	19	23	8	3	8	15	25	11	7	15	M6X6	---	6	---	HCH-04
SB04B1	2	1.5X60°	55	23	25	10	4	13	14	28	13.5	8.5	16	M8X22	---	3	13	HC-04
SB05B1	2	1.5X60°	62	23	27	10	4	14	19	29	13.5	8.5	18	M8X22	---	12	---	HC-05
SB05N1	2	1.5X60°	54	23	25	10	4	12	14	28	13.5	8.5	16.5	M8X20	---	5	---	HS-05
SB06B1	2	1.5X60°	72	31	32	12	5	15	20	37	17	11	20	M10X30	---	12	---	HS-06, HCH-06, HC-06
SB08B1	2	1.5X60°	95	35	38	14	5	24	25	46	19	13	23	M12X35	---	12	---	HCH-08, HC-08, HS-08
SB10B1	2	1.5X60°	110	40	42	16	5	30	30	50	19	13	27	M12X35	---	15	20	HCH-10, HC-10, HS-10
SB12A1	1	1.5X60°	129	50	50	18	5	39	30	60	23	15	30	M14X45	---	---	---	HC-12, HCH-12
SB12N1	1	1.5X60°	111	50	50	21	4	21	30	60	25	17	33	M16X40	---	---	---	HS-12
SB15C1	1	1.5X60°	165	62	66	22	8	37	43	85	32	21	42	M20X80	---	---	---	HCH-15, HCH-18
SB15N1	1	1.5X60°	135	50	60	25.5	5	26	43	66	32	21	39	M20X55	---	---	---	HC-15, HC-18
SB18A2	1	3.0X60°	180	65	70	25	9	40	60	80	32	21	45	M20X60	---	---	---	HC-21, HC-24, HCH-21, HCH-24
SB32B2	1	3.0X60°	160	75	75	25.5	7	25	38	97	32	22	54	M20	---	---	---	HCH-32 (Serration)
SB32GB	3	---	165	75	83	12.7	13	21.9	76.2	---	32	22	59	M20	---	19.025	---	HC-32 (Groove)
SB32SB2	1	3.0X60°	185	75	75	25.5	7.5	26.8	38.1	82	32	22	57	M20	82	---	---	HC-32 (Serration)
SB40B2	1	30.X60°	270	110	110	30	7.5	32.5	60	---	39	26	90	M24	117.5	---	85	HC-40 (Serration)
SB40GB	3	---	270	110	117	30	15	48.8	76.2	76.2	39	26	90	M24	68.8	19.025	---	HC-40 (Groove)