

KITAGAWA[®] POWER CHUCKS

BB200 SERIES

SUPER LARGE BORE POWER CHUCKS

Three-jaw super bore power chucks are ideal for bar chucking requiring large bore and small chuck diameter. These chucks deliver consistent accuracy and repetitive chucking.

SPECIAL FEATURES:

- * Compact and Lightweight
- * Super big thru-hole
- * High accuracy and high endurance

MODEL	UNIT	BB206	BB208	BB210	BB212
THRU-HOLE	IN.	2.087	2.598	3.189	4.173
JAW STROKE (DIA)	IN.	0.217	0.291	0.346	0.394
PLUNGER STROKE	IN	0.472	0.630	0.748	0.906
MAX. DRAW BAR PULL FORCE	LBS.	4,935	7,178	10,947	13,235
MAX GRIPPING FORCE	LBS.	14,800	22,210	28,266	34,325
MAX. SPEED	RPM.	6,000	5,000	4,500	3,500
NET WEIGHT	LBS.	28	53	70	125
GD2	LGS FT2	5.5	13.0	25.5	60.0
MATCHING CYLINDER	----	SS1453 S1552	SS1666 S1875	SS1881 S2091	SS2110S F2511H00

GRIPPING CHARACTERISTIC GRAPH BB200

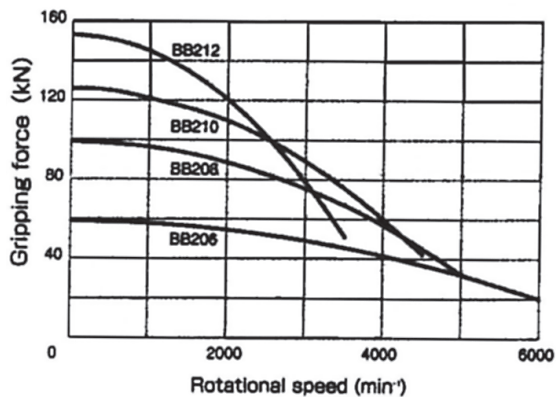

*The graph using standard soft jaws is shown above.

Model BB200 Seires Chucks are manufactured from high grade alloy steel. All sliding surfaces are hardened and ground to assure consistent accuracy and performance.

Lubrication nipple in each base jaw.

Master Jaw Serrations:

Chuck size 6" to 12" 1.5mm x 60 degree

Mounting:

Direct mounting to fit ASA B5.9 type A (interchangeable with DIN 55026).

Standard Equipment:

Chuck assembled with adapter, chuck mounting bolts, soft top jaws, T-nuts, and jaw mounting bolts with wrench, draw nut wrench.

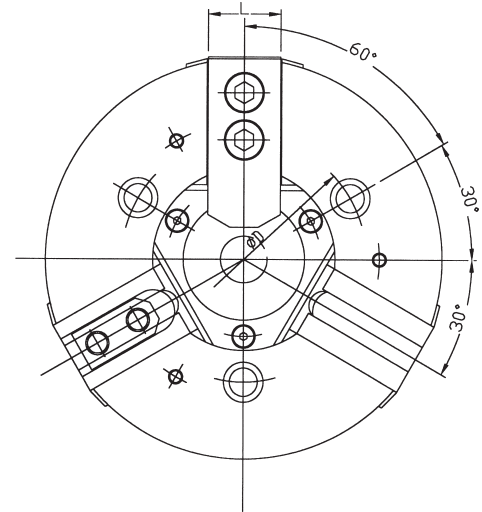
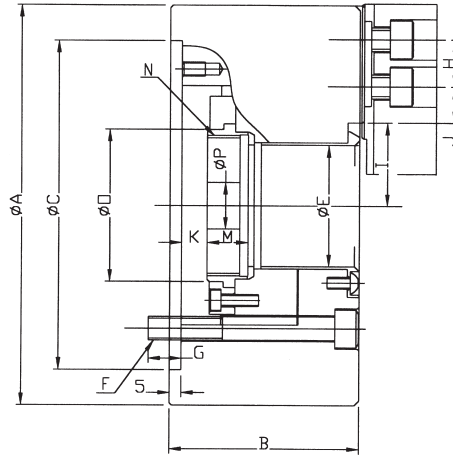

MODEL	BB206	BB208	BB210	BB212
A	6.693	8.268	10.000	12.402
B	3.188	3.583	3.937	4.252
C	5.512	6.693	8.661	11.811
D	4.126	5.252	----	9.252
E	2.087	2.598	3.189	4.173
F	3xM10	3xM12	3xM16	3xM16
G	0.630	0.638	1.063	1.063
H	0.787	0.984	0.984	1.181
I MAX.	1.417	1.799	2.126	2.638
I MIN.	1.309	1.654	1.953	2.441
J MAX.	.0837	0.935	1.270	1.801
J MIN.	0.423	0.463	0.561	0.620
K MAX.	0.433	0.571	0.335	0.315
K MIN.	-0.039	-0.059	-0.413	-0.591
L	1.307	1.378	1.575	1.969
M	0.689	0.787	1.102	1.102
N MAX.	M60x2.0	M74x2.0	M90x2.0	M115x2.0
O	2.598	3.150	3.376	4.882
P	0.787	1.181	1.772	1.969